



SUSTAINABLY DEVELOPING THE OUTBACK



Notes:

1. For full list of chainages for towns in Diamantina Shire, please refer to the DSC-R Town Chainages spreadsheet.
2. Address Numbering in accordance with Campbell Higginson Town Planning report 'Street Numbering System for Diamantina Shire Council' dated 19/10/2010.

LEGEND

- 10 Used Address
- 24 Unused/Reserved Address
- 0.0 Start of Street Chainage
- 420.0 End of Street Chainage
- ↑ Direction of Chainage
- ▶ Direction of Chainage
- Town Street/Road
- Street Name
- Road Reserve/Street Area

**DIAMANTINA SHIRE COUNCIL
URBAN ADDRESSING & TOWN
STREET CHAINAGES -
BEDOURIE (1 of 2)**



Information contained herein is the intellectual property of George Bourns & Associates and will not be copied without written authorisation from George Bourns & Associates.

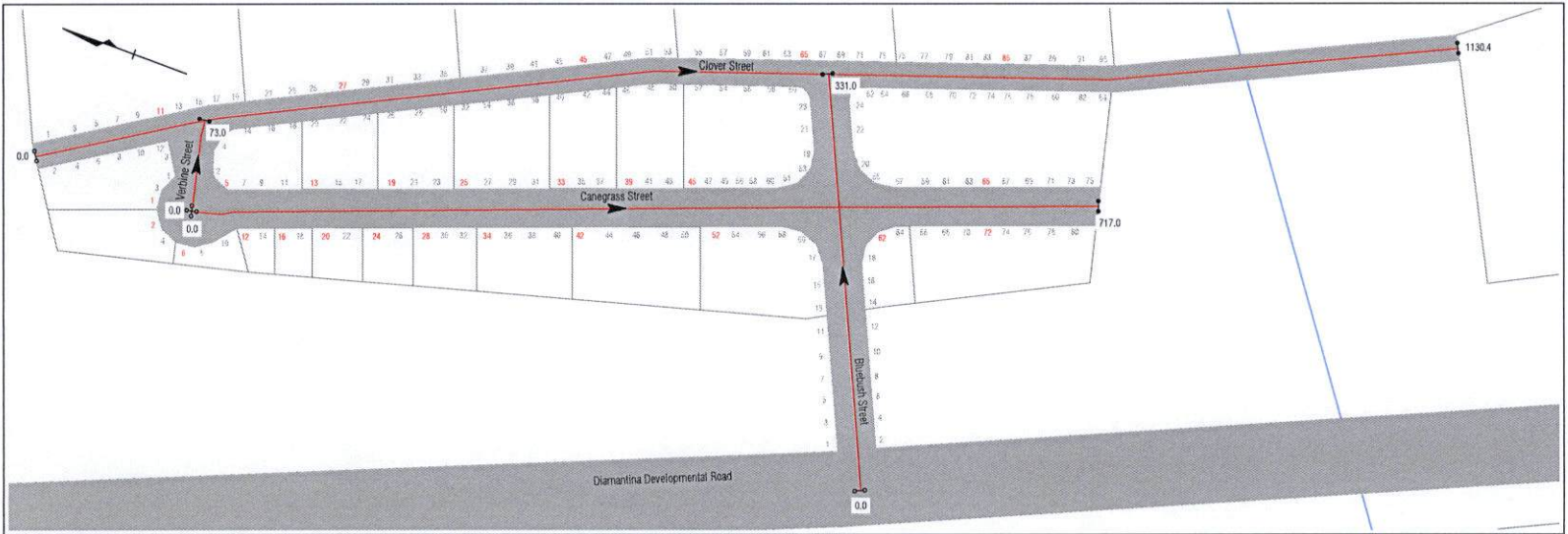

Bedourie Northern Subdivision

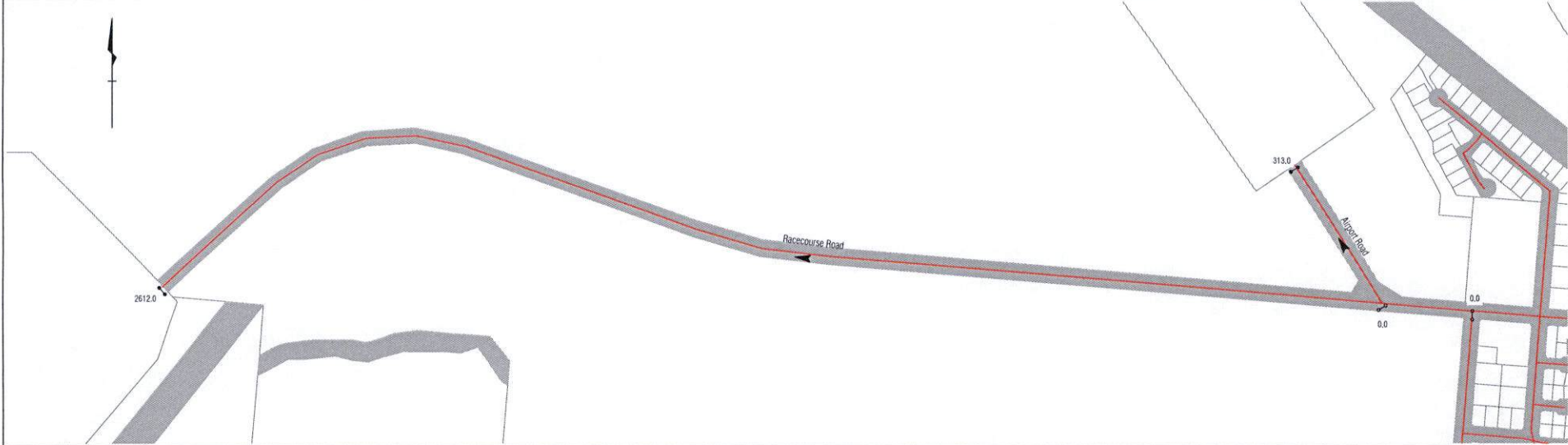

Bedourie Non-Urban Streets

Notes:

1. For full list of chainages for towns in Diamantina Shire, please refer to the DSC-R Town Chainages spreadsheet.
2. Address Numbering in accordance with Campbell Higginson Town Planning report 'Street Numbering System for Diamantina Shire Council' dated 19/10/2010.

LEGEND

- 10 Used Address
- 24 Unused/Reserved Address
- 0.0 Start of Street Chainage
- 400.0 End of Street Chainage
- ▶ Direction of Chainage
- Town Street/Road
- Street Name
- Road Reserve/Street Area

**DIAMANTINA SHIRE COUNCIL
URBAN ADDRESSING & TOWN
STREET CHAINAGES -
BEDOURIE (2 of 2)**

Printed: 24/05/2021 11:27:15